

Targus

CHILL MAT PLUS

with 4-PORT USB HUB

22-2571

1 YEAR LIMITED WARRANTY: We pride ourselves on the quality of our products. For complete warranty details and a list of our worldwide offices, please visit www.targus.com. Features and specifications are subject to change without notice. All trademarks and registered trademarks are the property of their respective owners.
©2012 Targus Group International, Inc.



User Guide

Introduction

Thank you for your purchase of the Targus Chill Mat Plus with 4-Port USB Hub. It keeps your laptop cool, plus provides additional USB ports to connect your peripherals. The adjustable height lets you choose from a variety of angles. Use it flat with just your laptop, or use it at the highest setting with an external keyboard.

Features

- 2 USB powered fans
- Integrated 4-port USB 2.0 hub
- Adjustable angle, from flat to 4" high
- Velcro loops to keep your cables neat
- Rubber feet and bottom ledge keep laptop secure

System Requirements

- USB 1.1/2.0 compliant port

To Use the Chill Mat

1. Place the Chill Mat on a surface, such as a table.
2. Position your laptop on top of the Chill Mat.
3. If you have purchased the optional AC power adapter, connect one end into the Chill Mat's DC port and the other end into the power outlet.
4. Connect one end of the USB cable into the mini-B USB port located at the rear of the Chill Mat.
5. Connect the other end of the USB cable into an available USB port on your laptop computer.

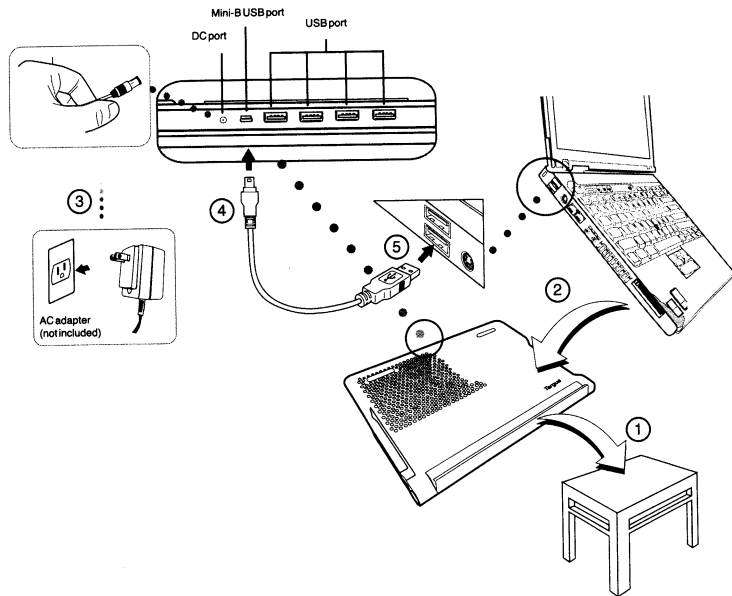

NOTE: If there's insufficient power after connecting USB devices to the Chill Mat, you may purchase and use the separately sold AC Adapter (Targus model number APA09USZ) on www.targus.com to provide more power to the USB devices.



WARNING: KEEP ALL ITEMS, SUCH AS LOOSE CLOTHING AND JEWELRY, AND LONG HAIR AWAY FROM THE FANS TO AVOID POSSIBLE PERSONAL INJURY OR DAMAGE TO THE CHILL MAT OR YOUR LAPTOP.

Technical Support

For technical questions, please visit:

US

Internet: www.targus.com/support.asp

Australia

Internet: www.targus.com/au

Email: infoaust@targus.com

Telephone: 1800-641-645

New Zealand

Telephone: 0800-633-222

Product Registration

Targus recommends that you register your Targus accessory shortly after purchasing it. Go to:

<http://www.targus.com/registration.asp>

You will need to provide your full name, email address, country of residence and product information.

Warranty

Targus warrants this product to be free from defects in materials and workmanship for one year. If your Targus accessory is found to be defective within that time, we will promptly repair or replace it. This warranty does not cover accidental damage, wear and tear, or consequential or incidental loss. Under no conditions is Targus liable for loss of, or damage to devices; nor loss of, or damage to, programs, records, or data; nor any consequential or incidental damages, even if Targus has been informed of their possibility. This warranty does not affect your statutory rights.

Regulatory Compliance

This device complies with Part 15 of the FCC Rules. Operation is subject to the following two conditions: (1) This device may not cause harmful interference, and (2) This device must accept any interference received, including interference that may cause undesired operation.

FCC Statement

Tested to Comply

This equipment has been tested and found to comply with the limits of a Class B digital device, pursuant to Part 15 of the FCC Rules. These limits are designed to provide reasonable protection against harmful interference in a residential installation. This equipment generates, uses, and can radiate radio frequency energy and if not installed and used in accordance with the instructions, may cause harmful interference to radio communications. However, there is no guarantee that interference will not occur in a particular installation. If this equipment does cause harmful interference to radio or television reception, which can be determined by turning the equipment off and on, the user is encouraged to try to correct the interference by one or more of the following measures:

- Reorient or relocate the receiving antenna;
- Increase the separation between the equipment and receiver;
- Connect the equipment into an outlet on a circuit different from that to which the receiver is connected;
- Consult the dealer or an experienced radio/TV technician for help.

Changes or modifications not authorized by the party responsible for compliance could void the user's authority to operate this product.

Microsoft, Windows, and Windows Vista are either registered trademarks or trademarks of Microsoft Corporation in the United States and/or other countries. All trademarks and registered trademarks are the property of their respective owners. All rights reserved. Features and specifications are subject to change without notice. © 2012. Targus Group International, Inc. and Targus, Inc., Anaheim, CA 92806 USA